

Pandora would like to thank you for choosing  
our smart watch

# **Pandora** WATCH2

Our web-site: [pandorainfo.com](http://pandorainfo.com)

Customer support: [support@pandorainfo.com](mailto:support@pandorainfo.com)

EAC CE

QUICK GUIDE

## TABLE OF CONTENTS

|  |          |                                |           |
|--|----------|--------------------------------|-----------|
| <b>Set</b>                                     | <b>3</b> | <b>Mange a security system</b> | <b>8</b>  |
|  |          | Arming/Disarming               | 9         |
|  |          | Remote engine start            | 10        |
| <b>General information</b>                     | <b>3</b> | <b>Updating software</b>       | <b>11</b> |
| <b>Getting started</b>                         | <b>6</b> | <b>Warranty obligation</b>     | <b>11</b> |
| Starting Pandora Watch 2                       | 6        | Warranty card                  | 12        |
| Pairing Pandora Watch 2 with a security system | 6        |                                |           |
| <b>Charging</b>                                | <b>7</b> |                                |           |

## SET

|                   |   |
|-------------------|---|
| 1. Pandora Watch2 | 1 |
| 2. Band           | 1 |
| 3. USB-cable      | 1 |
| 4. Quick guide    | 1 |
| 5. Packaging      | 1 |

**!** THE MANUFACTURER RESERVES THE RIGHT TO CHANGE THE SET AND CONSTRUCTION OF THE PRODUCT TO IMPROVE ITS TECHNOLOGICAL AND OPERATIONAL PARAMETERS WITHOUT A NOTIFICATION.

## GENERAL INFORMATION

Pandora Watch2 is a wrist-wearable device designed to conveniently control automotive or moto vehicles equipped with Pandora Bluetooth systems (compatible firmware versions: BT4.2 - v2.21 and higher, BT5.0 - v3.08 and higher, BT5.2 – all versions).



**ATTENTION!** The full manual and relevant information will be updated on the web-site: [pandorainfo.com/shop/pandora-watch-2/](http://pandorainfo.com/shop/pandora-watch-2/)

Scan the QR-code to go to the web-site!

- Shockproof housing
- Shockproof glass
- IP rating - IP67
- Color display 1.34 (320x300)
- 256 MB RAM
- Bluetooth 5.0 interface
- Li-Po Battery, 3.7V, 250mAh
- GPS/GLONASS-receiver
- 3D-accelerometer
- Sealed micro-USB connector
- Sound indicator
- Vibro-indicator
- 5 Control buttons

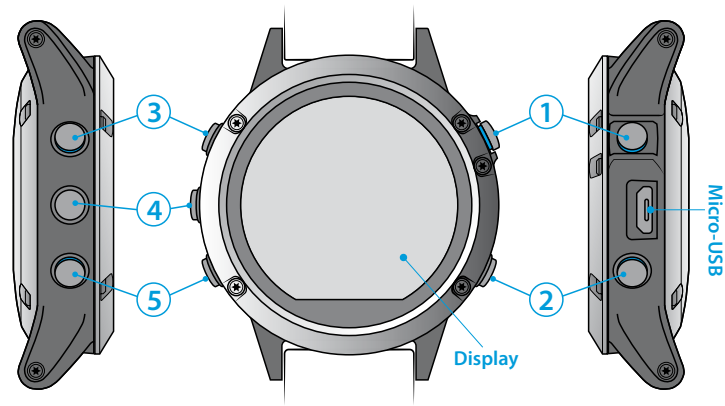

PANDORA WATCH2

| BUTTONS | NAVIGATION | FUNCTIONS   |
|---------|------------|---|
| ①       | Select     | <b>TURN ON THE WATCH</b> – press and hold the button for 3 seconds.<br><b>NOTIFICATIONS</b> – briefly press the button, the second press will cause notification switching.<br><b>UPDATE SOFTWARE</b> – hold the button and connect the watch to a PC via a USB-cable while holding the button (See the “Update firmware” section). |
| ②       | Back       | <b>CHECK VEHICLE STATE</b> – briefly press the button. To update vehicle state information, go to the CHECK menu and press and hold the ⑤ button, release the button when the indicator loads to the middle of the progress bar.  |
| ③       |            | <b>ARMING/DISARMING</b> – press and hold the button, release the button when the indicator loads to the middle of the progress bar.   |
| ④       | Up         | <b>REMOTE ENGINE START</b> – press and hold the button, release the button when the indicator loads to the middle of the progress bar.  |
| ⑤       | Down       | <b>MENU</b> – briefly press the button.   |

QUICK GUIDE

## GETTING STARTED

### Turn on the watch

The watch are ready to use at the moment of shipment. Press and hold the **1** button for 3 seconds. If you are not able to turn on the watch, try to charge the battery using a USB-cable (see the "Charging" section).

### Pairing Pandora Watch 2 with a security system

It is required to pair the Pandora Watch2 with a Pandora security system. Prepare the watch, charge the battery and turn on the watch in accordance with the manual. The pairing procedure should be carried out near the security system (no more than 10 meters).

---

! THE SECURITY SYSTEMS CAN WORK ONLY WITH ONE BLUETOOTH DEVICE: PANDORA WATCH 2 OR A REMOTE D800/D030.

---

! UPDATE SOFTWARE OF THE WATCH AND SECURITY SYSTEM (BASE UNIT FIRMWARE AND BLUETOOTH MODEM FIRMWARE) BEFORE PAIRING.

- Enter the programming level №1 "Pairing remote controls" in accordance with a security system manual.
- Put the watch in the pairing mode:
  - Open the main Menu of the watch, briefly press the **5** button;
  - Select the "Settings" menu by **5** and **4** buttons and press the **1** button to open the "Settings" menu;
  - Select the "Bluetooth" menu by **5** and **4** buttons and press the **1** button to open the "Bluetooth" menu;
  - Select the "Vehicle" menu by **5** and **4** buttons and press the **1** button to open the "Vehicle" menu;
  - Briefly press the button **1**, to start the pairing procedure, "Searching for device" text will appear on the display;
  - "Found" message will appear when the search is completed. Press the **1** button to finish pairing.

- The security system will confirm pairing with a beep from a siren/ beeper. Finish pairing in accordance with the security system manual and exit the programming mode.

## CHARGING

There is a battery level indicator on the screen. Charge the battery if you are not able to turn on the watch or the indicator shows low value (10%).

Charge is carried out using a standard USB cable:

- Connect a micro-USB connector of a cable to the watch;
- Connect a USB connector to a charging device (not included in the set);
- Charge the battery until the charge indicator is full (100%);
- Disconnect the cable after charging. The watch is ready to use.

If the watch is off, press and hold the button **1** for 3 seconds to turn it on.

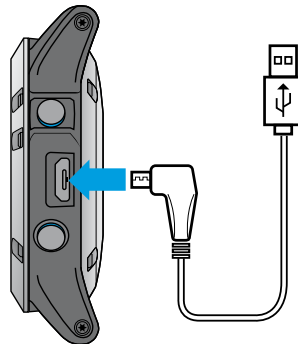

## MANAGE A SECURITY SYSTEM

When the watch is in the Bluetooth coverage zone of a security system, you can manage the system. The following icon  will appear in case of loss of communication.

Ways to manage the system:

- Arming/disarming by buttons on the watch housing;
- Automatic arming/disarming in HandsFree mode.

---

**!** SECURITY SYSTEM MANAGEMENT IS AVAILABLE ONLY FROM THE WATCH THAT WAS PREVIOUSLY PAIRED WITH THIS SYSTEM.

---



**!** TO USE THE WATCH AS AN AUTHORIZATION DEVICE FOR THE FOLLOWING OPERATION MODES: HANDSFREE, IMMOBILIZER, ANTIHIJACK, PROHIBIT DISARMING WHEN A TAG IS ABSENT IT IS REQUIRED TO SET THE FOLLOWING SETTING OF THE SECURITY SYSTEM. ENABLE "USE D-030 REMOTE AS A TAG" (MAIN SETTINGS -> RADIO TAG AND MOBILE DEVICE FUNCTIONS). WE RECOMMEND THAT SETTINGS OF THE SECURITY SYSTEM ARE PERFORMED BY A PROFESSIONAL SPECIALIST WHO HAS INSTALLED THE SECURITY SYSTEM

## Arming/Disarming

### Arming/Disarming by buttons

To arm/disarm the system, press and hold the  button, release the button when the indicator loads to the middle of the progress bar.

### Automatic arming/disarming (HandsFree mode)

- Move away (with the watch) from your vehicle to arm the system .
- Move toward (with the watch) your vehicle to disarm the system .

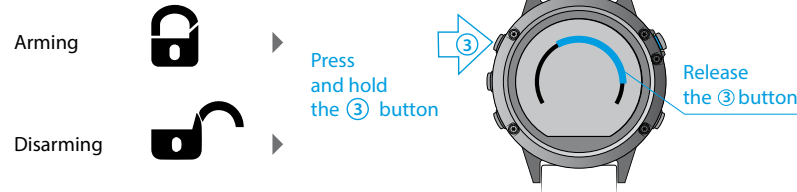

## Remote engine start

- To start the engine (if the system is ready to start), press and hold the **4** button, release the button when the indicator loads to the middle of the progress bar.
- To stop the engine (if the engine is running), press and hold the **4** button, release the button when the indicator loads to the middle of the progress bar.



Start  
Engine



Press and hold  
the **4** button

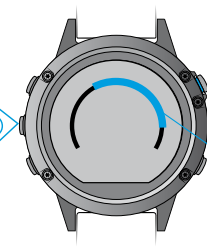

Release  
the **4** button

## UPDATE FIRMWARE

- Install the Pandora Alarm Studio app to a PC with Windows XP/Vista/7/8/10.
- Run the Alarm Studio
- Connect a USB-cable to the PC.
- Press and hold the **1** button, connect a USB-cable to the watch while holding the button. Release the button after connection. The watch will enter the boot mode.
- Press the "Update software" button and select a type of update: "Firmware archive" – software will be downloaded from a server to the "firmwares" folder; "Load from files" – select previously downloaded software.
- Select a software file and press the Update button.
- Disconnect the USB-cable after software is uploaded. The watch will go to the standard operation mode.

## WARRANTY OBLIGATIONS

Manufacturer guarantees correct operation of the device if exploitation, installation, storage and transportation conditions described in this manual were met.

The device should only be used according to installation scheme and user manuals. Parts malfunctioning during warranty period on the fault of the manufacturer should be repaired or replaced by the manufacturer or by the certified center.

A customer loses the right for warranty services in the following cases:

- when the warranty period expires;
  - if exploitation, storage or transportation conditions were not met;
  - if there is mechanical damage of the external parts of the device after it is sold, This includes: fire damage, aggressive liquids and water seeping damage, damage caused by improper use;
  - if manufacturer sealing is broken;
  - if there is no properly filled warranty card and installation certificate.

Warranty period is 3 years since the moment of purchase, but no more than 3,5 (three and a half) years since the moment of production. Maintenances and repairs of the device with expired warranty period are carried out at the expense of the user on a separate contract between a customer and the installer/service center.

This warranty doesn't cover the band, the batteries, as they have their own lifetime.

## Acceptance certificate

Serial number \_\_\_\_\_

Date of production \_\_\_\_\_

Responsible person signature \_\_\_\_\_

Stamp

Packager \_\_\_\_\_

signature (stamp)

## Warranty card

### Model **Pandora Watch2**

Serial number \_\_\_\_\_

Date of purchase « \_\_\_\_ » \_\_\_\_\_ 20 \_\_\_\_ y

Seller's stamp

Seller's signature \_\_\_\_\_